

DOWNTOWN MASTER PLAN

Allendale, South Carolina

The Town of Allendale, South Carolina needed a master plan for their small downtown area. Allendale is a small town that battles dwindling populations, low income and education levels, and lack of employment opportunities. But their citizens have great pride in their community and remain optimistic about the Town's future. SeamonWhiteside + Associates was retained to create this downtown master plan.

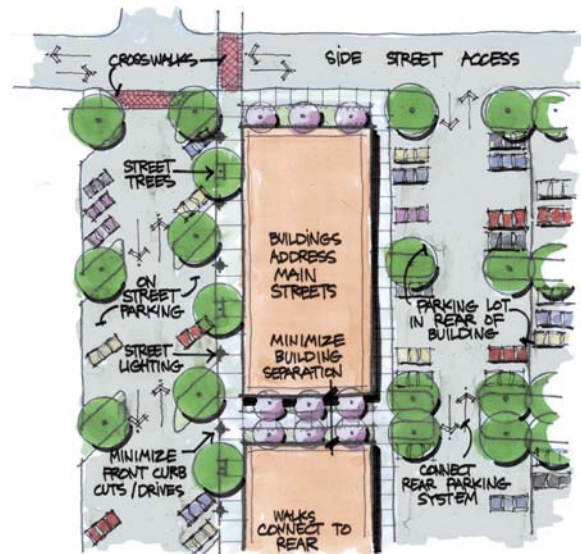
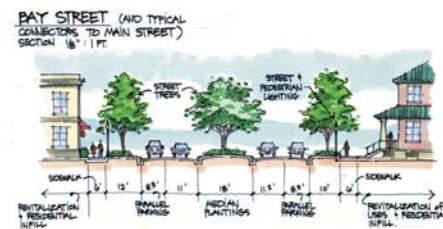

In late summer of 2007, SW+A conducted preliminary meetings with the Town and various stakeholders before leading an intensive design charrette. The charrette process included a public kick off meeting, a site walk, a very well attended and lively public workshop, and two days of concentrated design at a temporary office in the study area with a final presentation to the public at Town Hall. Coupled with SW+A's efforts our partner in the project, Arnett Muldrow Associates, prepared economic, marketing and demographic information to guide and inform future decisions. The master plan has been very well received and several projects are already in their formative stages as a result of the process.